

Koala
Sofa Bed
COVERS

Click the button
to watch the
assembly video

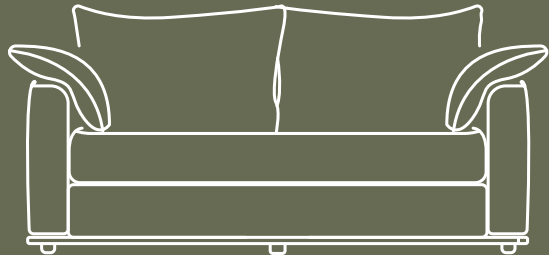

POKOL



What's in the box*

*Not to scale

x2



Easier assembly with two people



x2/x1

Queen Double/Single
Seat Pillow

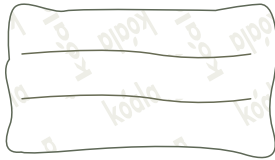

x2/x1

Queen Double/Single
Backrest Cushion

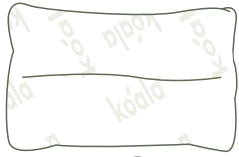

x2

Armrest Cushion

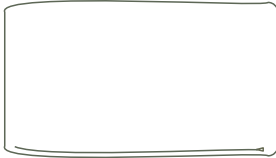

x2/x1

Queen Double/Single
Backrest Cushion Cover

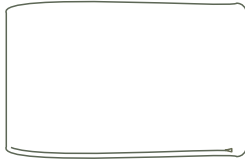

x2

Armrest
Cushion Cover



x1

Front
Edge Cover

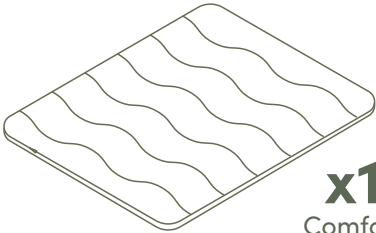

x1

Comfort
Topper

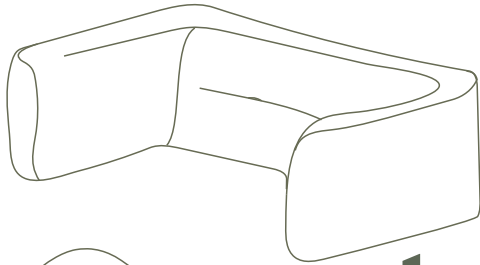

x1

Arm and
Back Cover

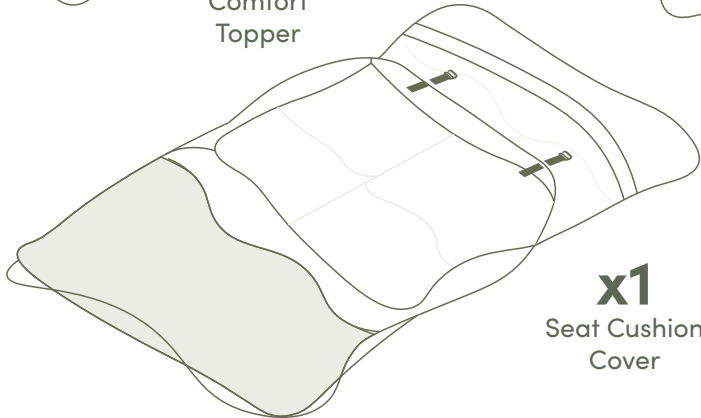

x1

Seat Cushion
Cover

1. Drape the cover over the frame. Using two hands, pull the cover over the Armrests so the corners are neat. Start from the bottom front of both Armrests.

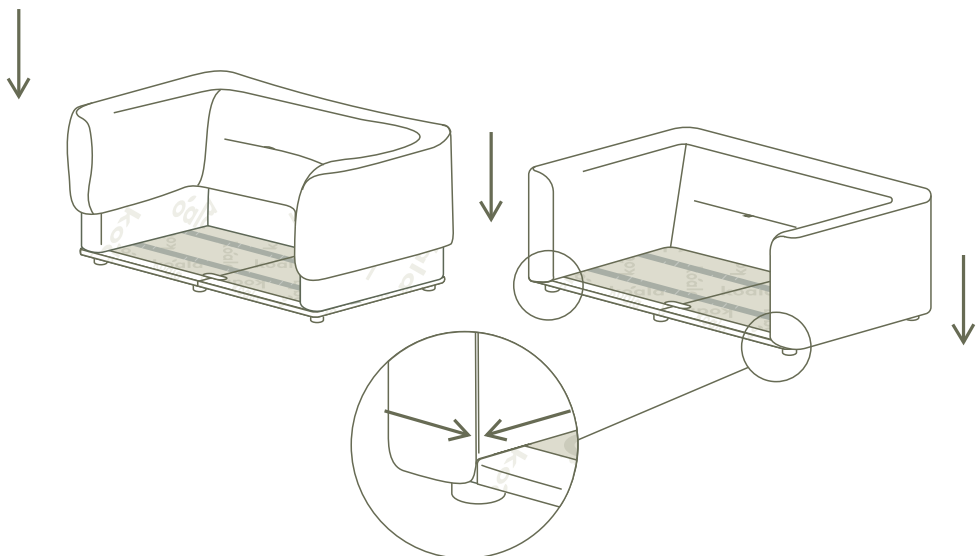

-
2. Pull the straps through the holes on the backrest.

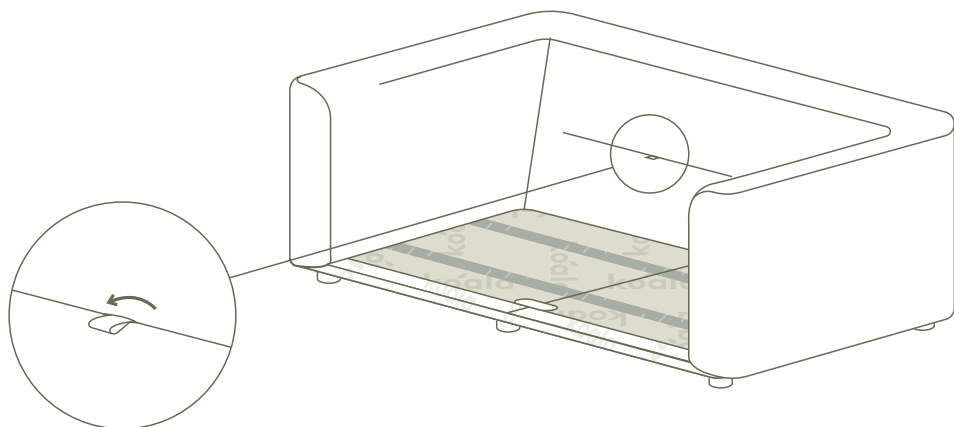

- 3.** Attach the front edge cover.
Pull tight along the length to eliminate gaps.

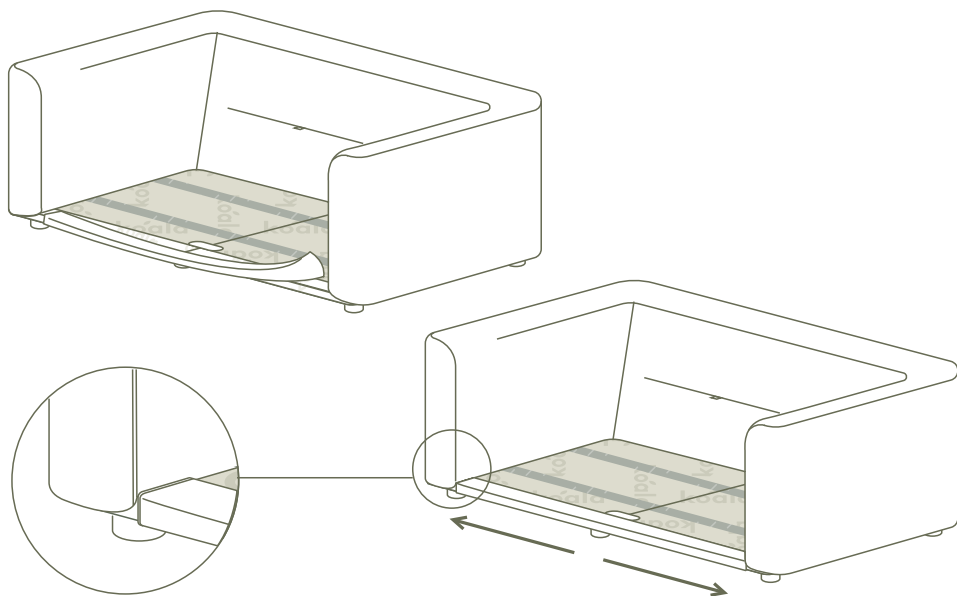

- 4.** Lay the seat cushion cover fabric side down on the ground.

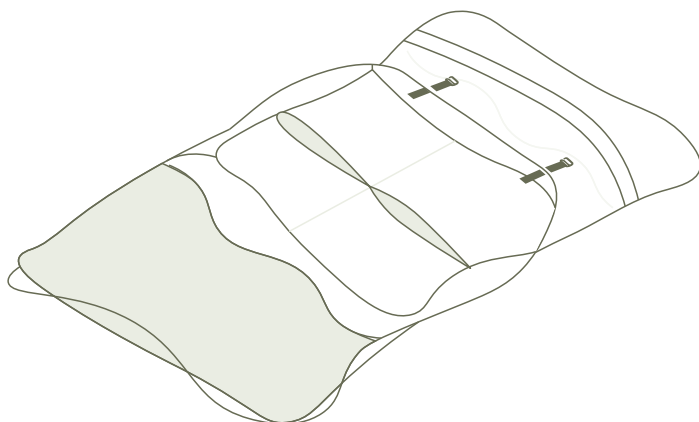

- 5.** Insert the seat pillows into the seat cushion cover and evenly distribute into all corners. Zip closed.

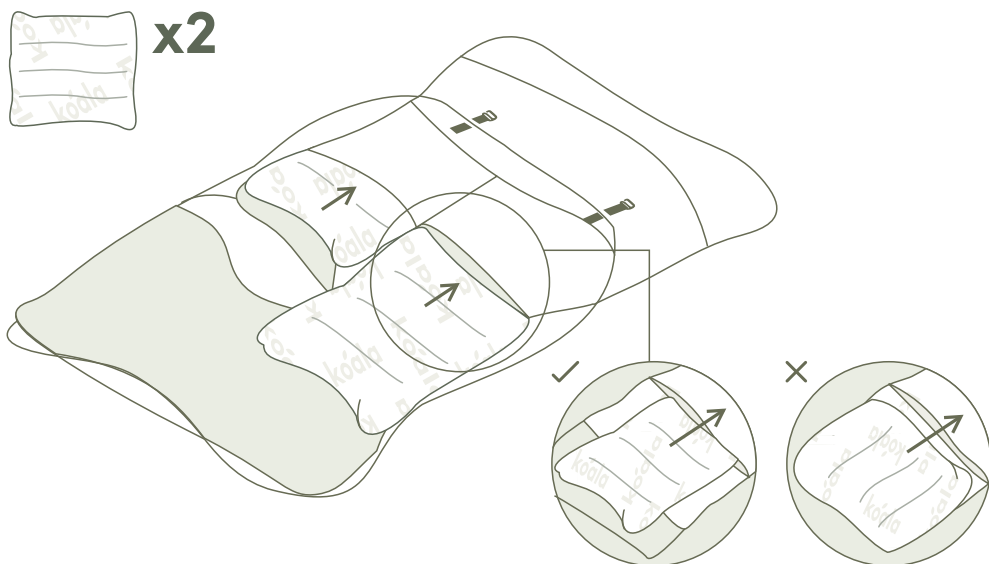

- 6.** Locate the colored tabs on the Seat cushion.

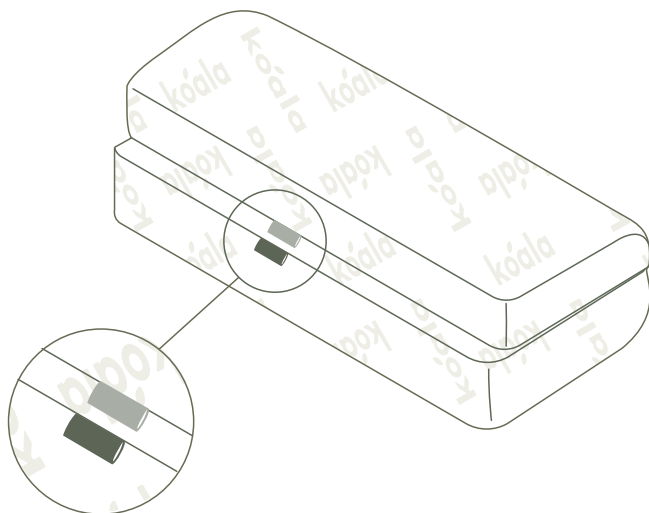

- 7.** Place the seat cushion on top of the cover so that the red tags are aligned on the bottom edge.

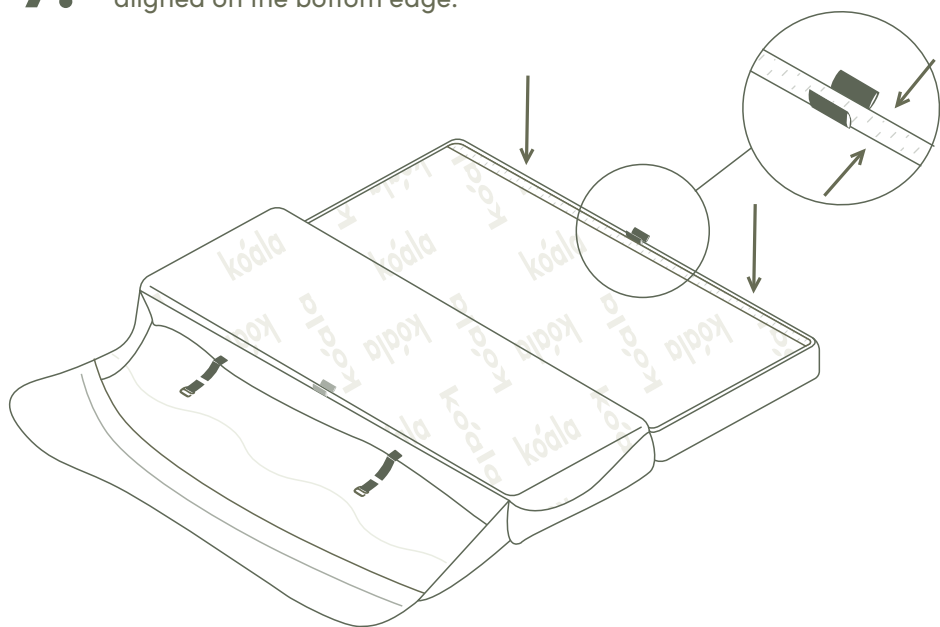

- 8.** Fold the cushion closed and zip the cover to the cushion.

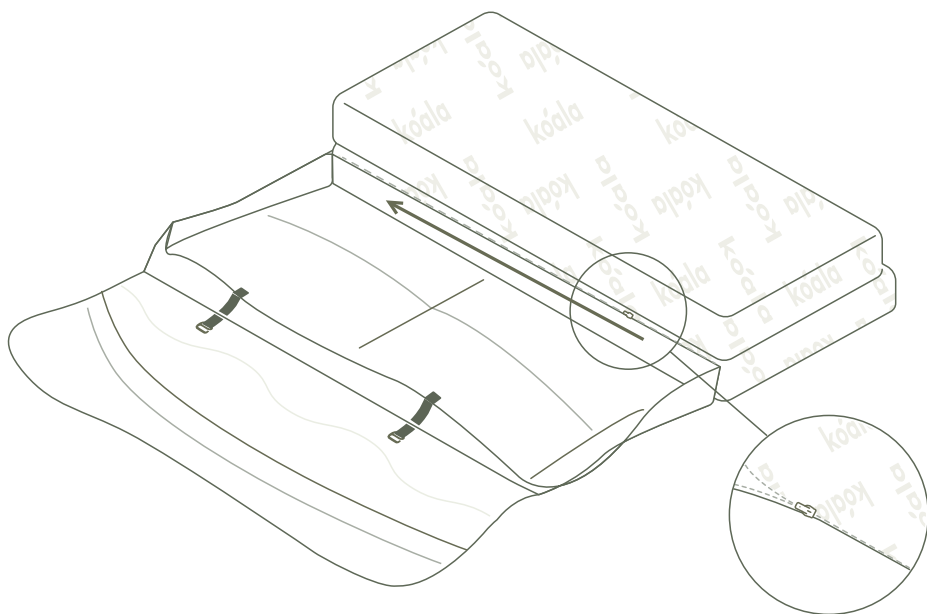

- 9.** Push down on the foam along the top edge of the cushion to secure the velcro.

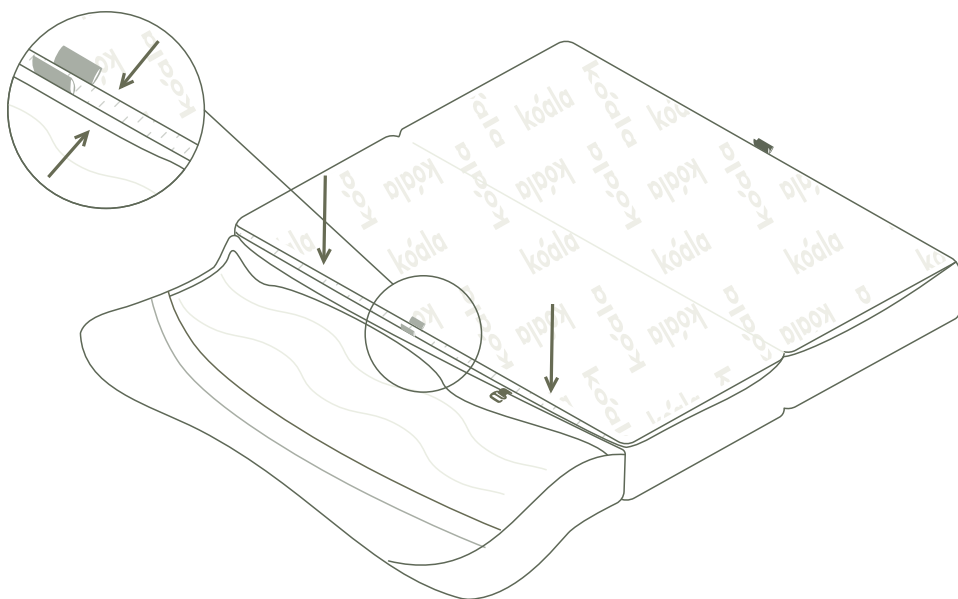

- 10.** Align the blue colored tab for the backrest with the cover. Insert the backrest cushion and close the zipper.

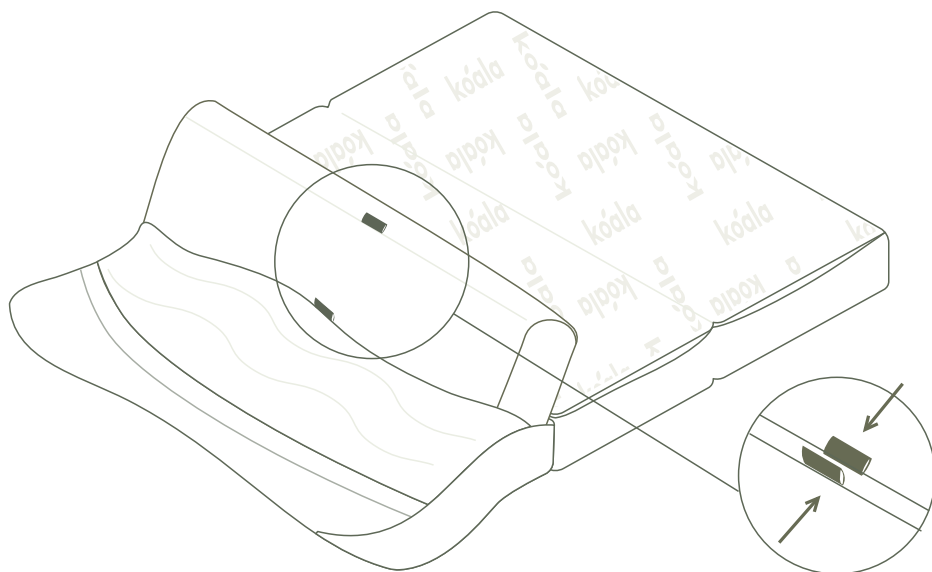

- 11.** Place the topper onto the sleep surface and align the colored tabs. Zip closed around the edge and fold the seat closed

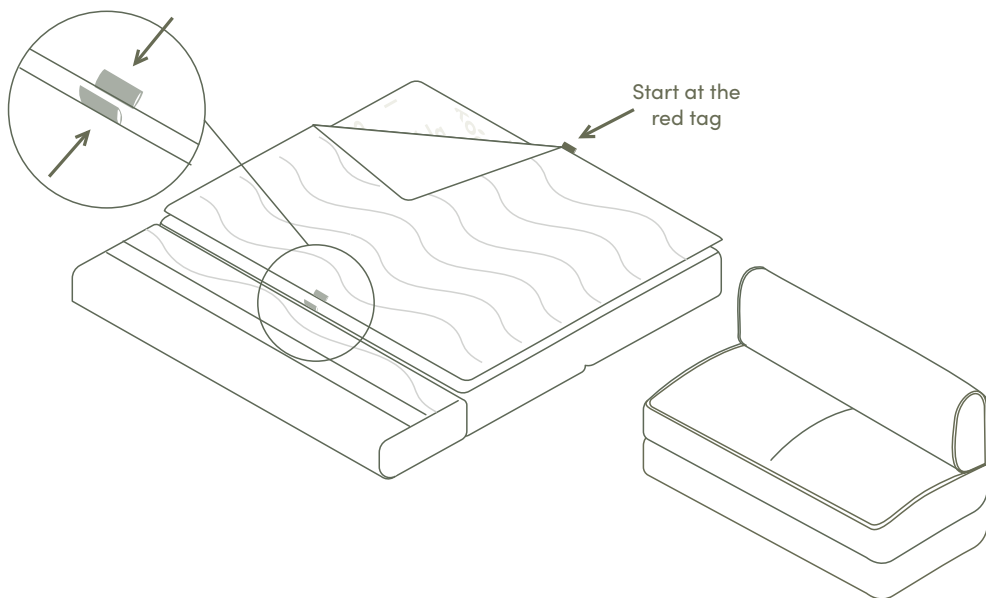

- 12.** Place the seat cushion onto the frame and secure by aligning the velcro.

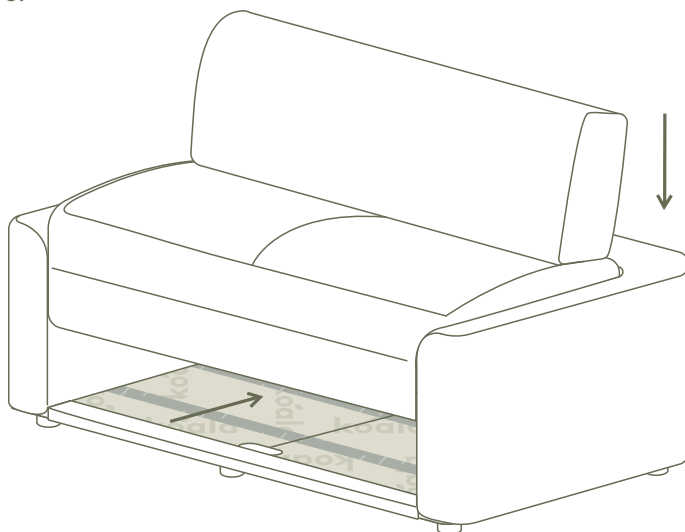

Ensure bottom cushion is pushed all the way against the backrest.

- 13.** Tilt the sofa onto its back and pull the strap through the square hole. Secure the strap in place using the gumnut.



x2

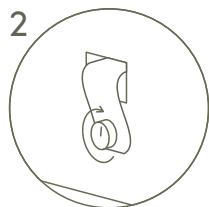
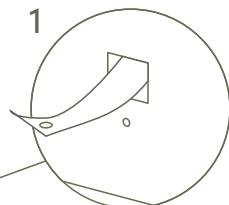
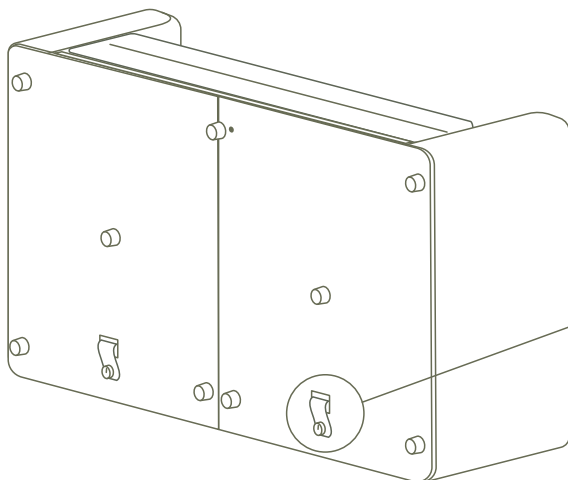

Heads up! If your strap is too short to attach, the cushion is not back far enough.

- 14.** Secure the seat in place by attaching the buckle to the loops behind the backrest.

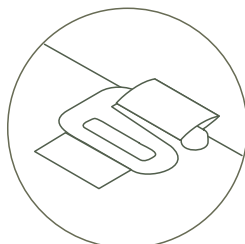
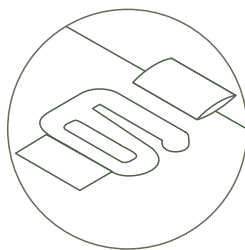
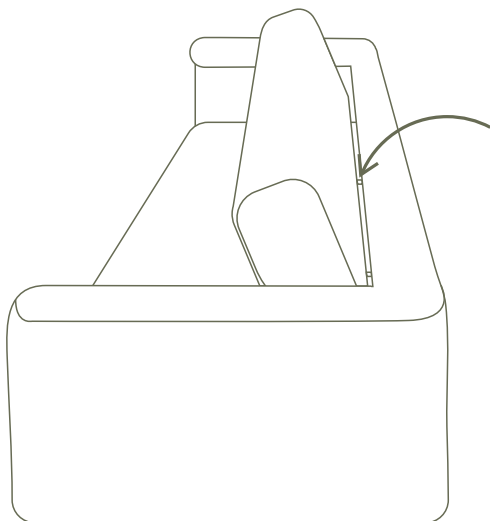

15. Insert Backrest and Armrest Cushions into their covers.



Heads up!
The covers and inserts are labeled

16. Place your backrest and armrest cushions on the sofa.

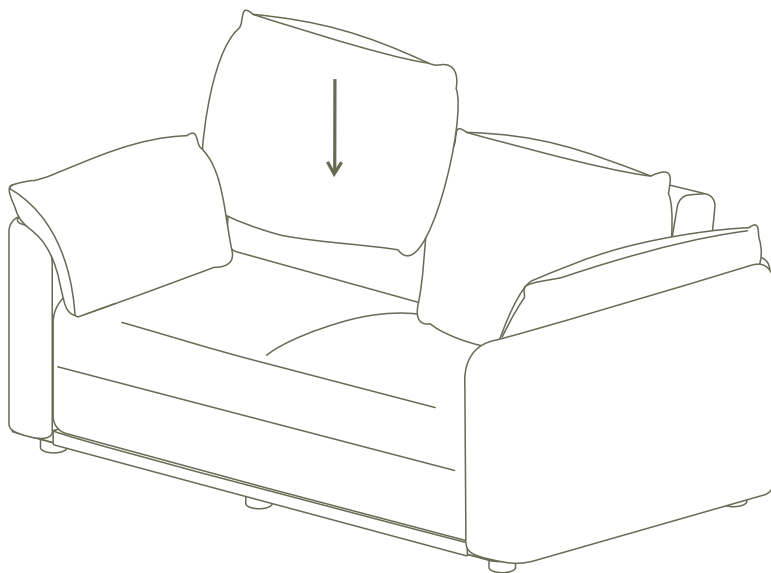

17. Converting to bed.

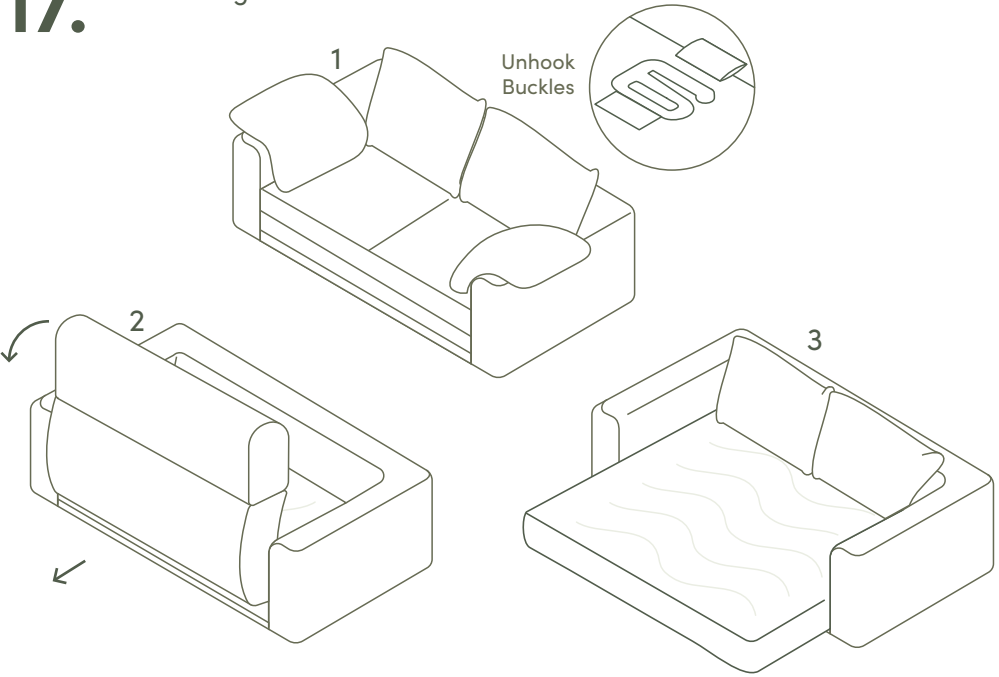

18. Converting to sofa.

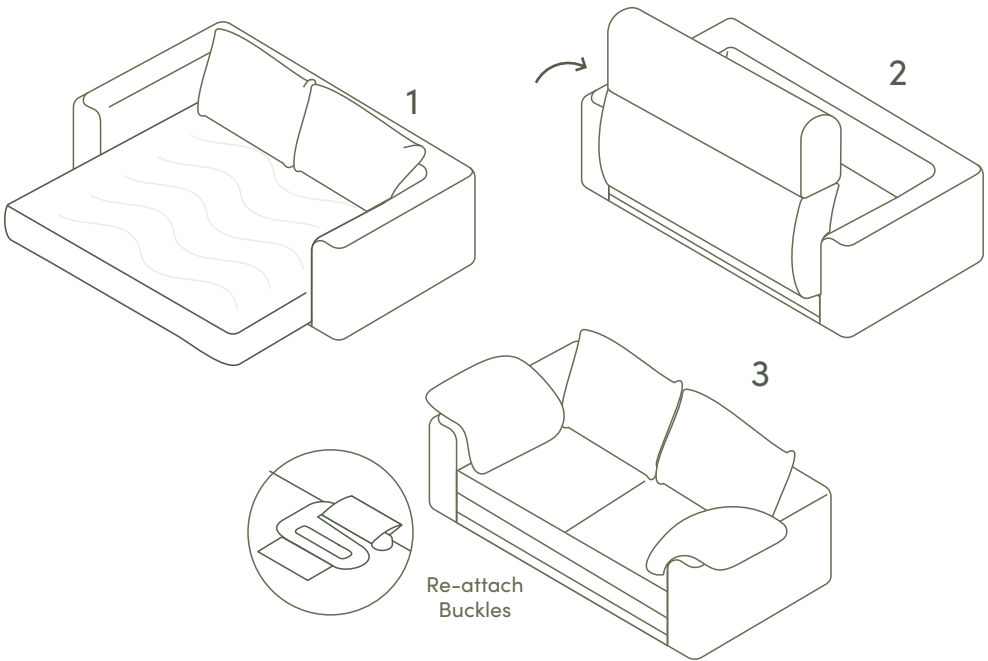

Cover Care Instructions

Your Koala Sofabed cover is removable and washable!
How good! Save this guide for when you wash your covers!

WASH INSTRUCTIONS

1

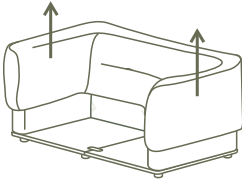

Remove your cover,
(follow steps 1-16 in
reverse order)

2

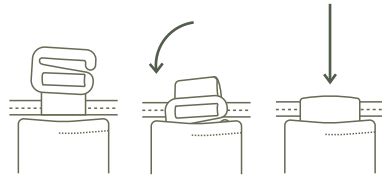

Tuck the buckles away

3

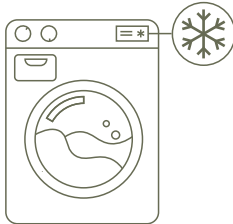

To prevent shrinkage,
cold machine wash

4

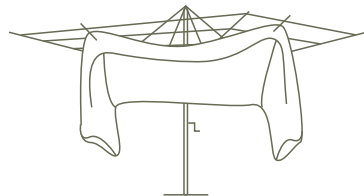

Line dry in shade

5

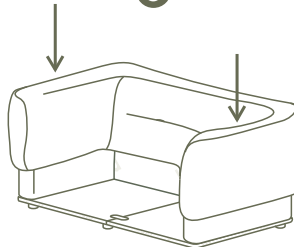

Re-fit the covers by
following steps 8 - 24

For even more detail, each cover has their own handy care labels.

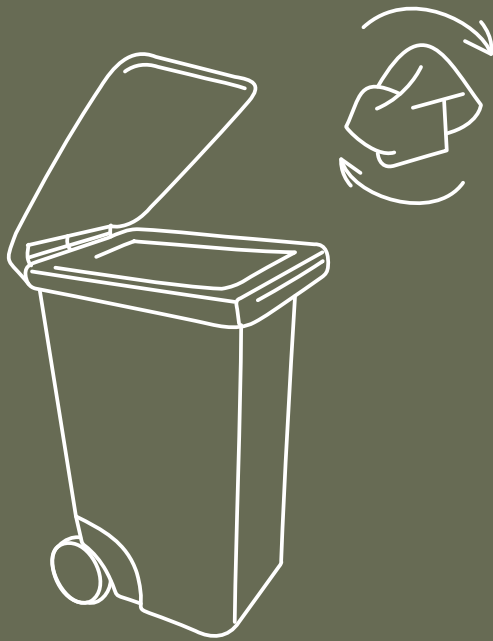

Don't forget to recycle.

kóala