

Koala
Sofa Bed
FRAME



What's in the box*

*Not to scale

x2



Easier assembly with two people



x6

Long Leg



x1

Short Leg

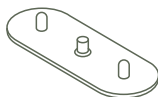

x1

Baseboard Connector



x2

Gumnut

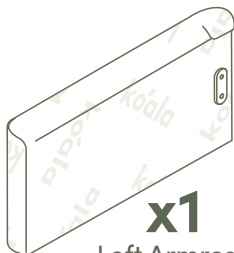

x1

Left Armrest

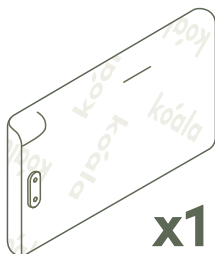

x1

Right Armrest

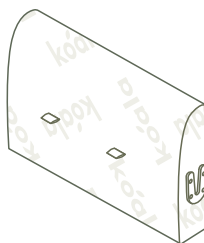

x1

Backrest

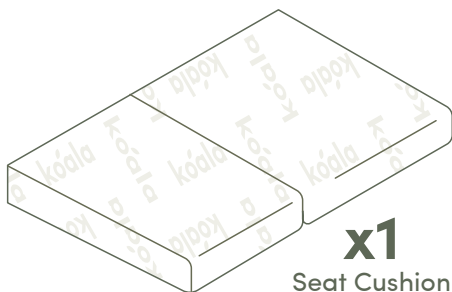

x1

Seat Cushion

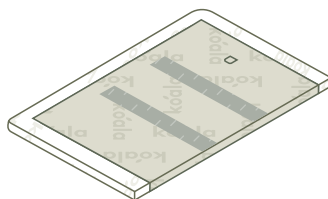

x2

Baseboard

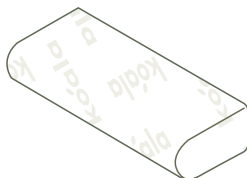

x1

Backrest Cushion



NOTE - Open the seat cushion box first.
Due to compression, max comfort reached after 3-5 days.

- 1.** Connect the two arms to the backrest using the wedge brackets.

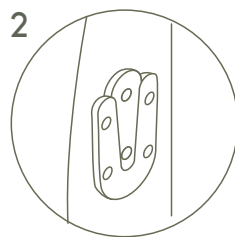
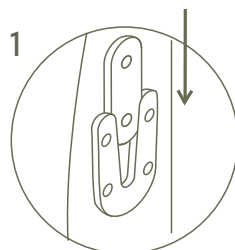
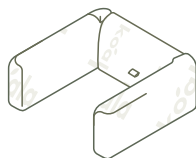
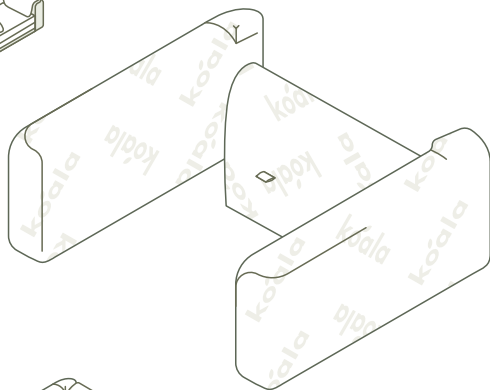
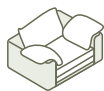

- 2.** Ensure sofa bed is positioned away from walls and carefully rotate the sofa bed on its back.

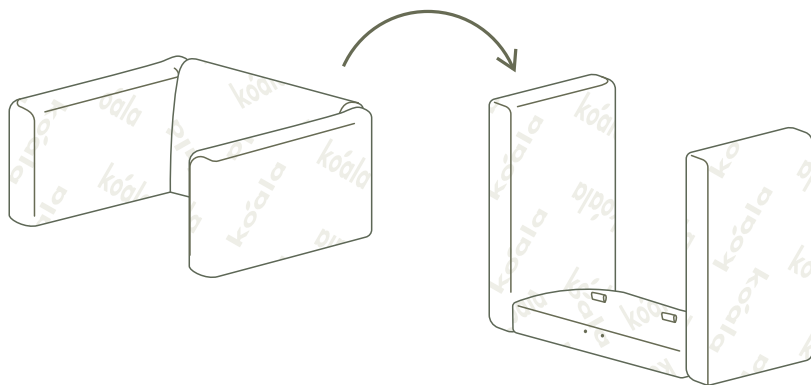

- 3.** Screw baseboard with green lining up, onto frame using long thread legs in the order shown.

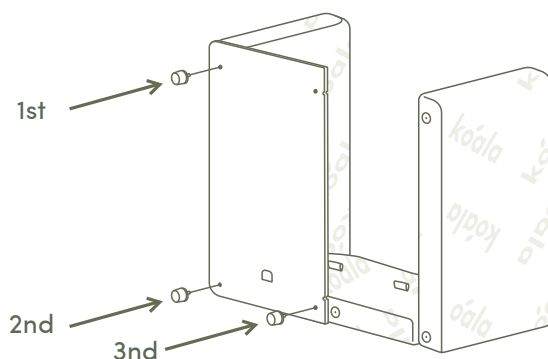

Use coloured stickers on armrest and backrest as alignment guide

- 4.** Screw second baseboard with the velcro facing in, onto frame using the longer length thread legs in the order shown.

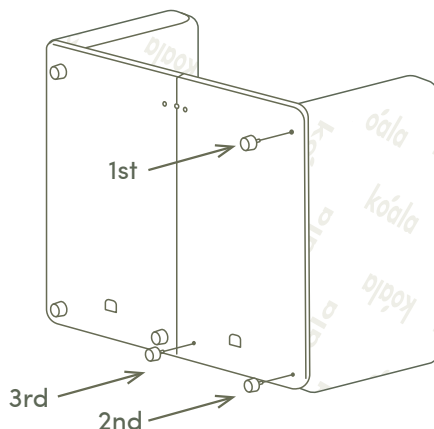

Use coloured stickers on armrest and backrest as alignment guide

5.

Screw in connector plate using the shorter thread leg.



x1



x1

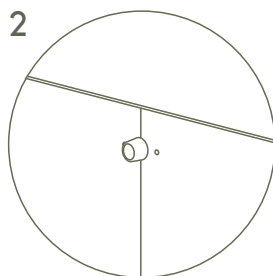
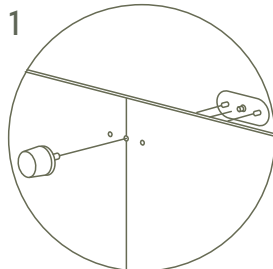
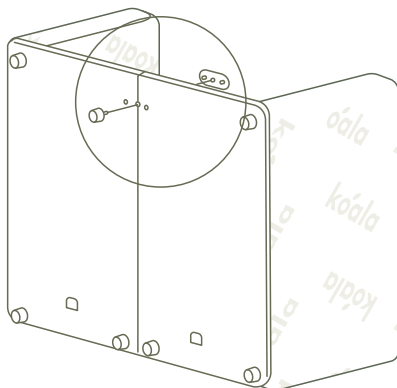

6.

Carefully lower the sofa bed on its legs.

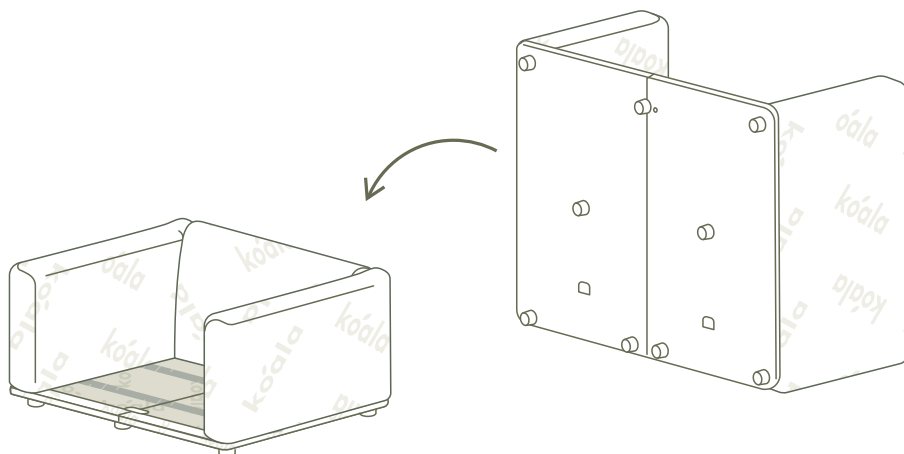

Cover instructions
located in the cover box



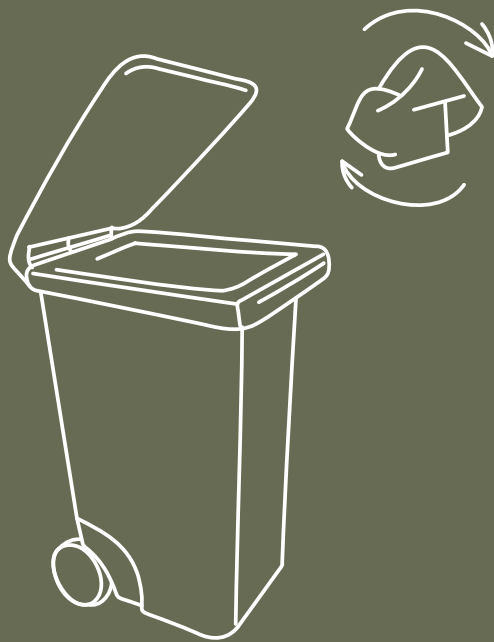

Don't forget to recycle.

kóala